

SMA Series

PRINTED CIRCUIT BOARD

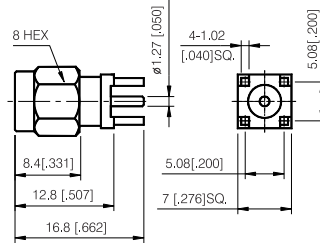
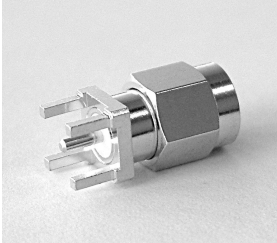

STRAIGHT PLUG FOR PRINTED CIRCUIT BOARD

P/N	Cable Group	Impedance
101-M610	N/A	50

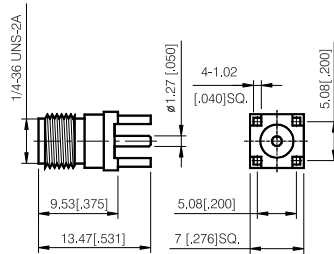
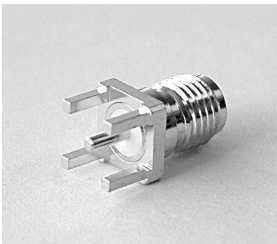

STRAIGHT JACK FOR PRINTED CIRCUIT BOARD

P/N	Cable Group	Impedance
101-F610	N/A	50

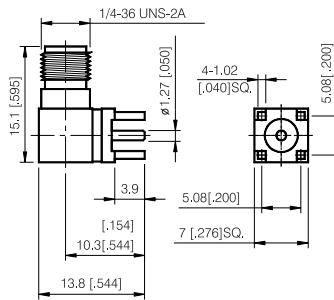
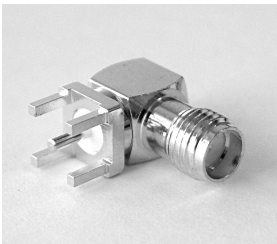

RIGHT ANGLE JACK FOR PRINTED CIRCUIT BOARD

P/N	Cable Group	Impedance
101-F620	N/A	50

SMA Series

PRINTED CIRCUIT BOARD

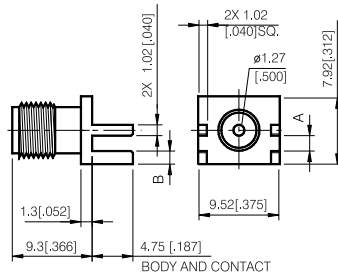
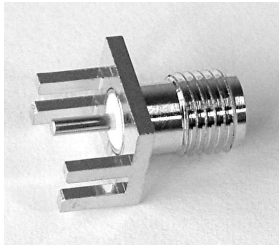

STRAIGHT JACK FOR PRINTED CIRCUIT BOARD

P/N	A	B	Impedance
101-F630	1.80(.068)	1.50(.059)	50

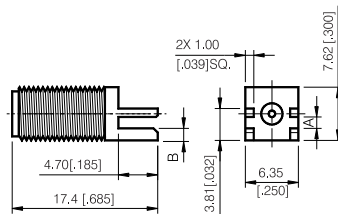

STRAIGHT JACK FOR PRINTED CIRCUIT BOARD

P/N	A	B	Impedance
101-F640	1.35(.053)	1.44(.057)	50

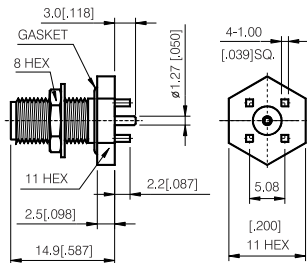
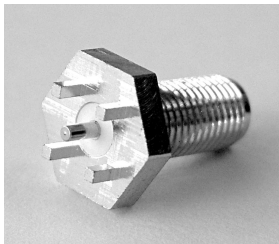

BULKHEAD JACK FOR PRINTED CIRCUIT BOARD WITH O-RING SEAL

P/N	Cable Group	Impedance
101-F670	N/A	50

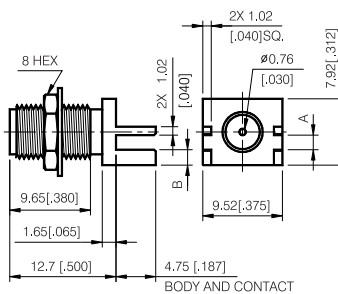

BULKHEAD JACK FOR PRINTED CIRCUIT BOARD

P/N	A	B	Impedance
101-F770	1.73(.068)	1.85(.073)	50
101-F771	1.91(.075)	1.68(.066)	50
101-F772	2.03(.080)	1.55(.061)	50

SMA Series

PRINTED CIRCUIT BOARD

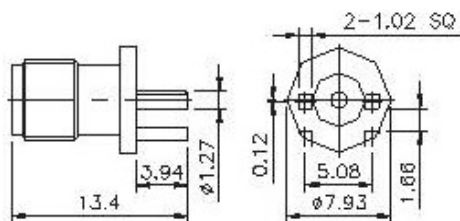

END LAUNCH JACK

P/N	Cable Group	Impedance
101-F870	N/A	50